

# Walls & Ceilings

## Low Frequency Tuner ME/LFT(X)2

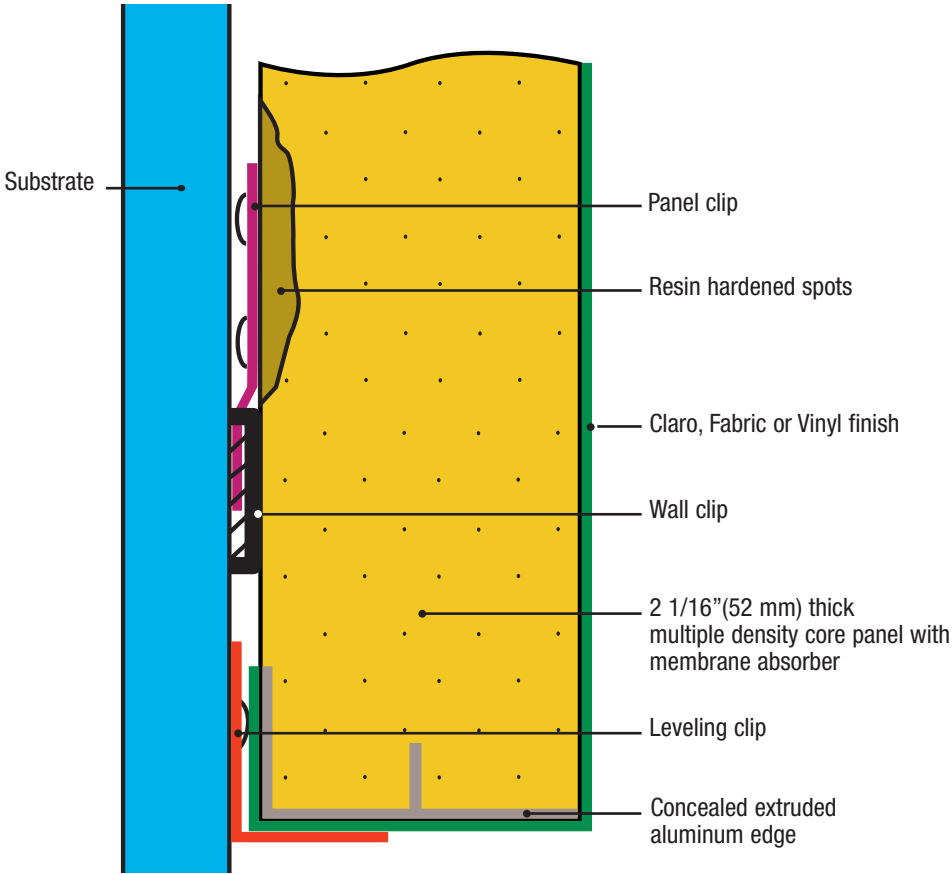

### Description

Decoustics Low Frequency Tuner acoustical wall and ceiling panels consist of a multiple density core, with a membrane type absorber (drumskin) located within the core. The face of the panel is then finished with a fabric or vinyl.

The installed panel provides acousticians with a method of controlling low frequency reverberation.

Available in optimum 2 1/16" (52 mm) thickness, panels are supplied complete with factory installed devices for mounting e.g. slide and engage z-clips secured to clips or continuous wall or ceiling track.

### Panels

All Decoustics panels are custom fabricated and offered in a variety of geometric shapes and finishes. ME/LFT(X)2 panels are currently only available flat, and with square edges.

### Design Considerations

When using speakers in ceiling or wall panels, it is recommended the speaker grille be visibly mounted at the face of the panel. Speaker function creates air movement and any fabric covering the speaker will experience premature soiling.

### Standards, Tests and Approvals

Surface Burning Characteristics (ASTM E-84):

All panel components have a Flame Spread rating of less than 25.

Note: Building code requirements may necessitate composite panel testing based on specified finish.

A panel comprised of "Class A" (Flame Spread of 25 or less) components does not necessarily produce a composite panel meeting the "Class A" requirement. Decoustics has a considerable number of composite panel tests on file.

Acoustical Data (ASTM C423: Type F5 Mounting as per ASTM E795).

**Decoustics Sound Absorption Data  
ME/LFTX2 (FR 701). Type F5 Mounting**

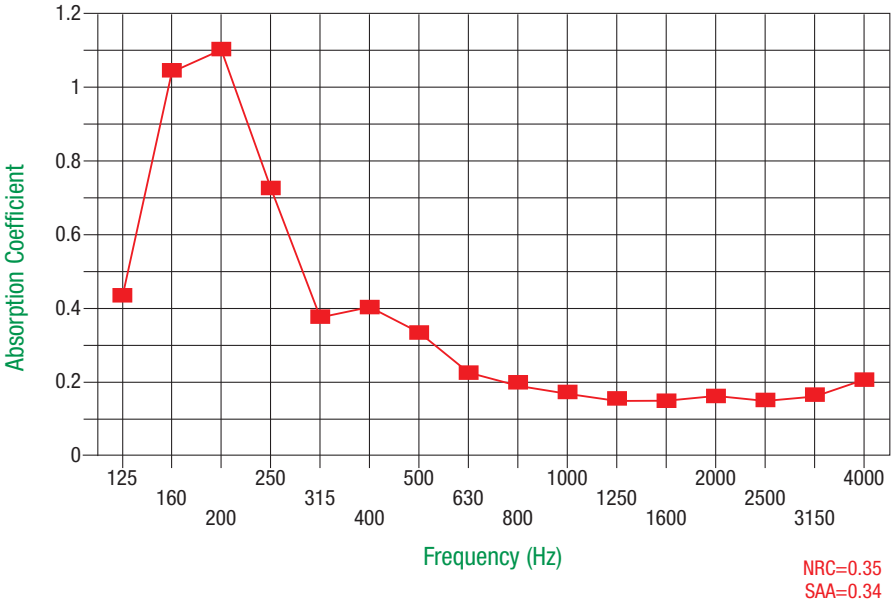

# Walls & Ceilings

## Low Frequency Tuner

ME/LFT(X)2

### Maintenance

Refer to appropriate Decoustics "Cleaning and Maintenance Instructions" for any specific finish.

### Related Data

Decoustics 3-Part Guide Specification.

### Mounting Methods

#### Walls

Mount panels using mechanical fastening only (includes slide and engage z-clips, wall clips and/or track). Consult with fastener manufacturer to determine correct fastener to use for specific substrates, particularly plaster or gypsum board. Note: It is not always possible to secure panels or mounting hardware to a substrate support such as a steel stud.

#### Ceilings

Mechanically mount only. Refer to ceilings section for appropriate suspension method.

| FINISH                          | EDGE OPTIONS  | SIZES  | CONSTRUCTION  | THICKNESS          | NRC | WEIGHT  |
|---------------------------------|---|--|---|--------------------|-----|---|
| Claro, Metallo, Fabric or Vinyl | Concealed Extruded Aluminum: square edge (defined). | Fabric or vinyl:<br>Up to 48" x 120"<br>(1220 mm x 3050 mm).<br><br>Claro / Metallo II:<br>Up to 48" x 72"<br>(1220 mm x 1830 mm). | Low Frequency Tuner consists of a multi-density core.<br>Fabric corners are fully tailored (no exposed darting). Vinyl corners are heat sealed. | 2 1/16"<br>(52 mm) | N/A | Approx.<br>1.6 psf<br>(7.81 kg/m <sup>2</sup> ) |

*Note: The information provided in this Data Sheet is accurate to the best of our knowledge at the time of printing. However, we reserve the right to make changes when necessary without further notification. Suggested applications may need to be modified to conform with local building codes and conditions. We cannot accept responsibility for products that are not used, or installed, to our specifications. Please refer to our website for most current data.*

*Note: Only handle panels wearing clean, lightweight, white gloves during installation. Follow manufacturer's printed instructions for installation as well as field cutting of panels.*